



the
UNIVERSITY
of
GREENWICH

URBAN COMPLEXITY OF HERITAGE AREA

case study: The informal settlements
of El-darb El-ahmar & El-hattaba

RASEM BADRAN

FEB. 16 - FEB. 20

workshop@msa.edu.eg

بولاية قلب القاهرة بدرية احياء



MAP ANALYSIS "CHARTS"

ARCHITECTURAL & URBAN ELEMENTS

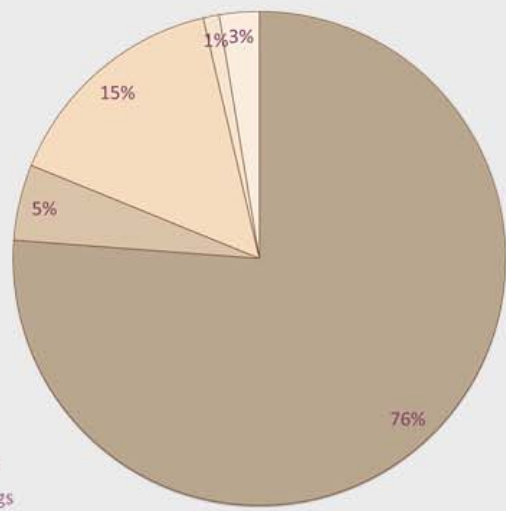

- Brick
- Deteriorating Brick
- Stones
- Deteriorating Stones
- Deteriorating Buildings

Building Conditions

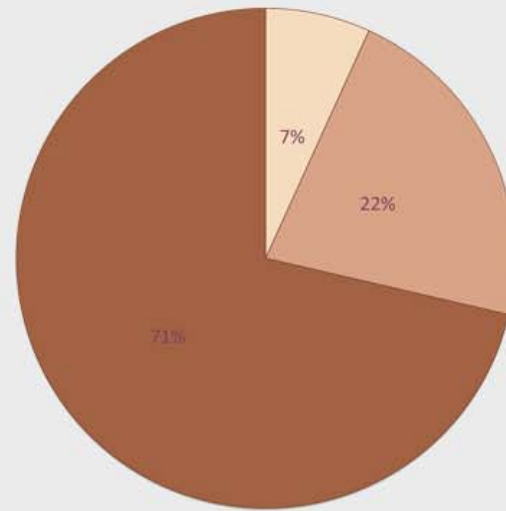

- Voids
- Streets
- Solids

Solid & Void

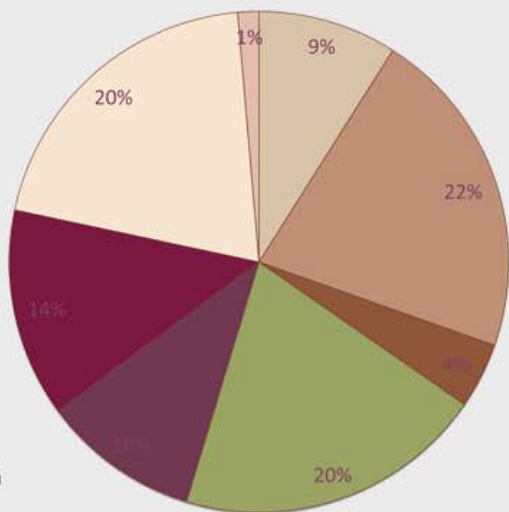

- Alty Baramak Mosque
- Ilgay Al-yousefy Mosque
- Gawhal Al-Lala Mosque
- Akhur Moque
- House of Ali Afandi Labib
- Morstn El Moe'eyad Sheih
- Al-Mahmoudya Mosque
- Hassan Fathy House

Landmarks

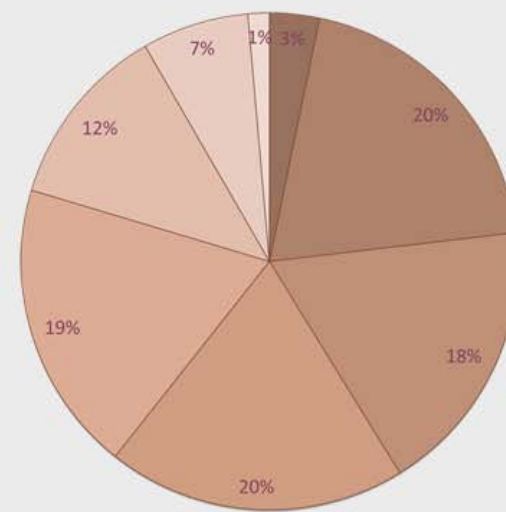

- 1 Floor
- 2 Floors
- 3 Floors
- 4 Floor
- 5 Floors
- 6 Floors
- 7 Floor
- 8 Floors

Building Heights

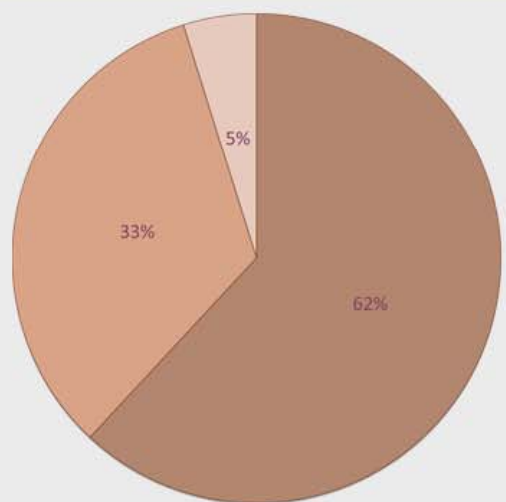

- Mixed Use
- Residential
- Historical

Land use

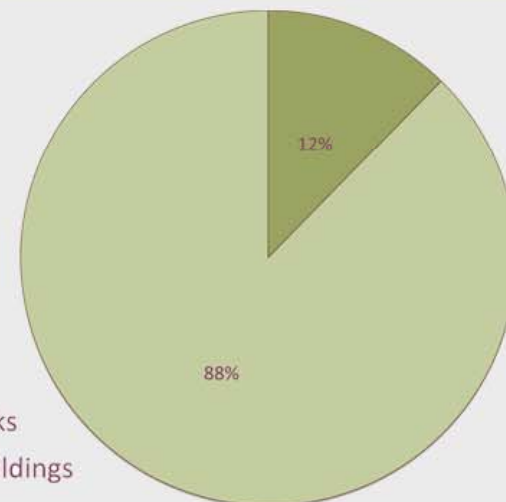

- Landmarks
- Other Buildings

Landmarks



CONTEXT

- STYLE (BUILDING) IN DIVERSITY
- DIFFERENT BUILDING MATERIALS (BRICK, STONE, ...)
- DIFFERENT BUILDING HEIGHTS (1 → 14) ← RANGE
- A LOT OF "IDENTITY" LESS BUILDINGS
- مبانى بلا هوية فى مكان تراش



★ (stolen) mashrabeya (?)
 ★ due to lack of knowledge of value of historical areas/ITEMS



NOTE:
 • LAYERING OF BUILDINGS (IN ITS OWN STRUCTURE AND AS A GROUP OF BUILDINGS)

SKYLINE

• Mosque has the highest sky lines because of their "He'azanna".



• SPACES AROUND MOSQUES AND HERITAGE PLACES HAVE HIGH FLOORS.
• NO X SPECIFIC SKYLINE



* dead ends & cul desacs *
* unused alleys => place for activities
* cannot be used as a parking space.



* MOSQUES ARE ABUNDANT IN OUR AREA
* a lot of historical places (like mosques) are not well preserved
* People do not know the value of these historical places

OPEN SPACES

How we can to use/reuse it depending on:

- _The main axes that link between the two important parts which are al sultan Hassan and Rifai mosque with al-Azhar park .
- _In addition with the main axis's how we can to exploit all the free spaces that facing the connector axis with courts have a shops or workshops for different handicrafts(that will help the Residents of the area from two directions) in addition of Provision a commercial facilitiesz.
- _Will shows two proposals(A,B) according to the place of the open spaces :

First Proposal :
With Greenline

Second Proposal:
With Rednline



The advantages of Proposal A :

- The link axis in the middle between two axes from Al-Sultan Hassan mosque (between two sides) .
- when you be in the main connector axis you will see all the surroundings monuments .
- and it will across a free spaces which will be used as a courts and handicrafts workshops or shops.

The advantages of Proposal B :

- when you be in the main connector axis you will see all the surroundings monuments .
- and it will across a free spaces which will be used as a courts and handicrafts workshops or shops.
- The main connector axis beginning with a gathering point with courts (Other Exploitation for a free space).

Problems

1) Services

- Only one school (EI SAFA WEI MARWA) (not close to everyone)
- No spaces for kids
- No Pharmacies
- No Activities

2) Residential

- garbage
- slip
- buildings out of context
- ↳ new concrete structure (lost identity)

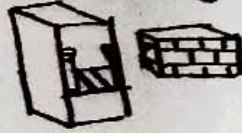

3) Planning

- very narrow streets
- parking places are too far away (not many)
- ↳ people end up parking in narrow streets & blocking them.
- *المشكلة في التخطيط*

4) Not well Preserved

- Historical monuments not well preserved
- pieces of Art (Mashrabiyas) sold or stolen

Possible Solutions

1) Services & Planning

- Baladeya
- Pharmacies do not need a lot of space
- Use the land to create a community service center (Recycling, Reuse...) → raising awareness
- ↳ getting rid of the garbage
- ↳ toys for kids *Taktok & Telefnik*
- ↳ self fulfillment & money.
- No soap → not allowed X → informal

2) Create a win-win scenario

- include them in decision making → sense of ownership
- improving their status → better jobs when they participate in building

3) Potential

- The place has the potential to become an attraction point "slums tourism"
- Linking the historical monuments creating a journey or experience
- Relationship or linkage to Azhar Park + SULTAN HAYAT



Irregular shape, No usage

Irregular shape, No usage

Irregular shape, No usage

Irregular shape, No usage

Irregular shape, No usage

Irregular shape, No usage

Irregular shape, No usage

Irregular shape, No usage

■ Open areas

■ Roads networks

■ Main spin

● Open spaces

SITE-RELATED PROBLEMS

Based on the site visit and on the careful study of the map, data and analysis provided, the following problems were detected:

A- Heritage-sites related problems

- Residents not being aware of the value of heritage sites.
- Some of the historical buildings are in a bad condition.
- People build residential buildings on the boundaries of the historical building not leaving any space around it.

B- Lack of Services

- Infrastructure and drainage problems.
- No Schools close to the area and therefore children walk longer distances to their schools.
- No garbage collecting service.

C-Lack of Recreational Areas

- No areas for the kids to play.
- No recreational areas for youth.
- No gathering areas for the community (markets/parks/Ahwa) .



SWOT ANALYSIS

E- Circulation Issues

- Streets are very narrow, yet cars manage to pass and park
- Some workshop owners complain that cars park in front of their shops
- No separate pedestrian paths



Strengths

Historical Monuments that should be an attraction in the area and that could help create a unique journey for both Egyptians and foreigners alike

Unique Location

1. Center of Historical Cairo
2. Between Salah El-Din Square and Azhar Park

Solid Historical Identity that brand the place with this unique feel (Fatimid or Olden Cairo)

Crafts and Handmade Works

Weaknesses

Street Width barely enough for humans and still occupied by cars

Crowded Areas no room for expansion both spatially, spiritually and communally

Infrastructure weak infrastructure would lead to damaged, unstable and deteriorating houses throughout the years



Opportunities

Crafts and Handmade Works failed to market these crafts

Topography & Demography for creating interesting pathways

Wasted & Vacant Spaces could be used as communal areas or be transformed into green areas

Cul-de-sac & Blocked Alleys could also be used as communal areas or could be transformed into green areas

Heritage Area & Rich Identity could be used as touristic attractions

Threats

Infrastructure and Unstable Buildings that applies on the very unstable buildings that are frozen between government permits and disuse

Informal Garbage Disposal System throwing garbage in the streets, and in monuments damages the value of both the monuments and the people living there

Lack Of Greenery and Ventilation Problems smog and pollution will eventually take its toll on the people if there are no ventilation outlets

there are some residential buildings needs to remove and some other needs to renew it.



Historical buildings needs restorations:
Historical building from different types of mosques or houses need restorations because its bad condition of construction.



Adding workshops and some green elements adding to soft and hard scape.



School:
USING THE SCHOOL TO SERVE OTHER SERVICES AND ENTERTAINING, CULTURAL PURPOSES LIKE EDUCATING PEOPLE ABOUT THEIR HERITAGE, HISTORICAL BUILDINGS AFTER SCHOOL DAY.



Garbage Dumps and Collection:
There could be designated garbage dumps known within every sector. Also at points where garbage trucks can fit and be able to collect the bags from the known locations.



Cul de sac (dead end):
The buildings in this area could be demolished and rebuilt as level in neighboring buildings therefore the inhabitants would still be able to live in the same sector/ region.



Topography:
Due to the difference in ground level (contouring) this spacious region could be used as an exhibition on to be on a higher level. This area will be used for bazars (Khan el Khalili inspiration).



Topography:
Due to the difference in ground level (contouring) this spacious region could be used as an open green space, with bazar/shops dug into the stone and an entrance/exit to the historical city from Sultan Hassan and Al Refaie Mosque.

EDUCATIONAL STRATEGY

SABIL & KOTAB ROQAYA DUDU

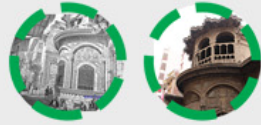

IT WAS BUILT AS A PLACE TO SERVE WATER FOR PEDESTRIANS AND AS A SCHOOL FOR CHILDREN TO LEARN QURAN



AL- REFAI SCHOOL

STRATEGY :

USING THE SCHOOL TO SERVE OTHER SERVICES AND ENTERTAINING, CULTURAL PURPOSES LIKE EDUCATING PEOPLE ABOUT THEIR HERITAGE, HISTORICAL BUILDINGS AFTER SCHOOL DAY.

ITS FACILITIES CAN ALSO BE USED FOR COMMUNITY SERVICES, FOR EXAMPLE, THE PLAYGROUND CAN BE OPEN FOR CHILDREN TO ENTERTAIN, SOME CLASSES CAN BE USED FOR HEALTH SERVICES.

THE SABIL ADJACENT TO THE SCHOOL CAN BE REUSED TO TEACH CHILDREN QURAN AGAIN AND/OR TO EDUCATE THEM ABOUT THE VALUE OF HISTORICAL BUILDINGS THROUGH OUT EXPERIENCING ONE OF THEM.



DEVELOPMENT OF THE PLAYGROUND OF THE SCHOOL AS A TYPE OF ENTERTAINMENT FOR CHILDREN AND TEENAGERS

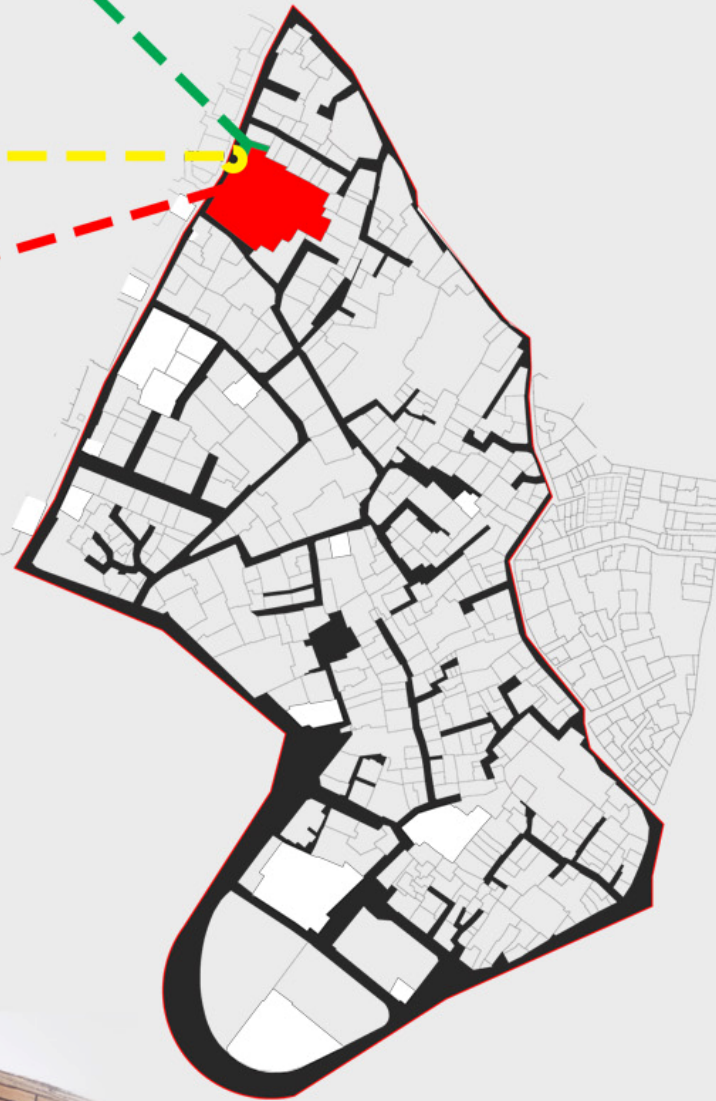

URBAN STRATEGY

- Open areas
- Roads networks
- Main spin
- Open spaces



Ground floors of some buildings can be used to open wider streets and can be used for other purposes such as commercial and exhibition.

sharing roofs between buildings for activities for recreational purposes.

shared open spaces between buildings for social interaction.



HARD & SOFTSCAPE



CUL DE SAC USAGE ..



CUL DE SAC USAGE ..



ARCHITECTURAL

Buildings needing restoration



Deteriorating buildings
 Most of these buildings can't be used again and are with no value, so they will be vanished. Their lands then will be used as open spaces or they will be reconstructed.

Historical buildings
 These building will need restoration and they will be open for people.

ENVIRONMENTAL



The roofs of the buldings are with no function, so they turned to a totally destroyed area full of garbage

The roofs will be turned to green areas with sitting areas



More green areas



Removing garbage and making fixed areas for them

SOCIAL, ECONOMIC & SERVICE

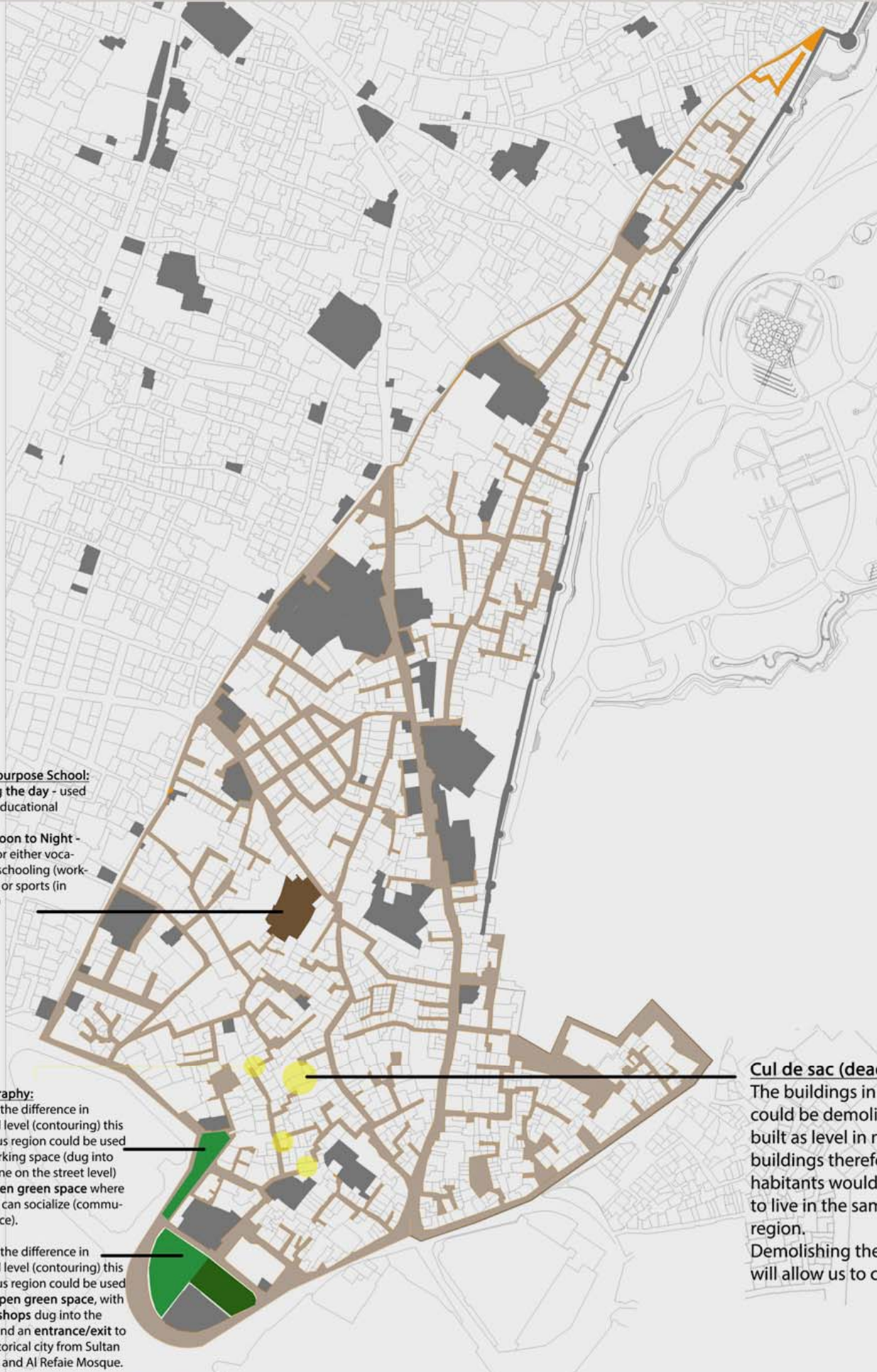

Multi purpose School:
During the day - used as an educational school
Afternoon to Night - used for either vocational schooling (workshops) or sports (in courts)

Topography:
Due to the difference in ground level (contouring) this spacious region could be used as a parking space (dug into the stone on the street level) and open green space where people can socialize (communal space).

Due to the difference in ground level (contouring) this spacious region could be used as an open green space, with bazar/shops dug into the stone and an entrance/exit to the historical city from Sultan Hassan and Al Refaie Mosque.

Cul de sac (dead end):
The buildings in this area could be demolished and rebuilt as level in neighboring buildings therefore the inhabitants would still be able to live in the same sector/region.
Demolishing the buildings will allow us to continue with



putting solutions for the services problems, and use it to upgrade the social and economic problems in the Area.
Example: the garbage problems:
it blocks the streets and the alleys and historical places. removing them will give us more places for social events and recycling them to increase the economic problem.

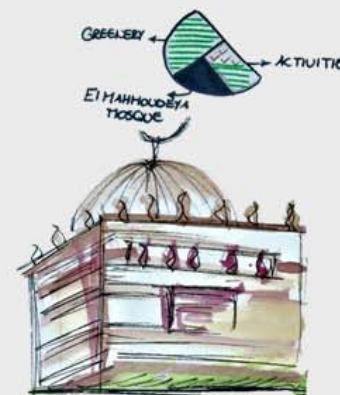

CULTURAL STRATEGY

Historical buildings:

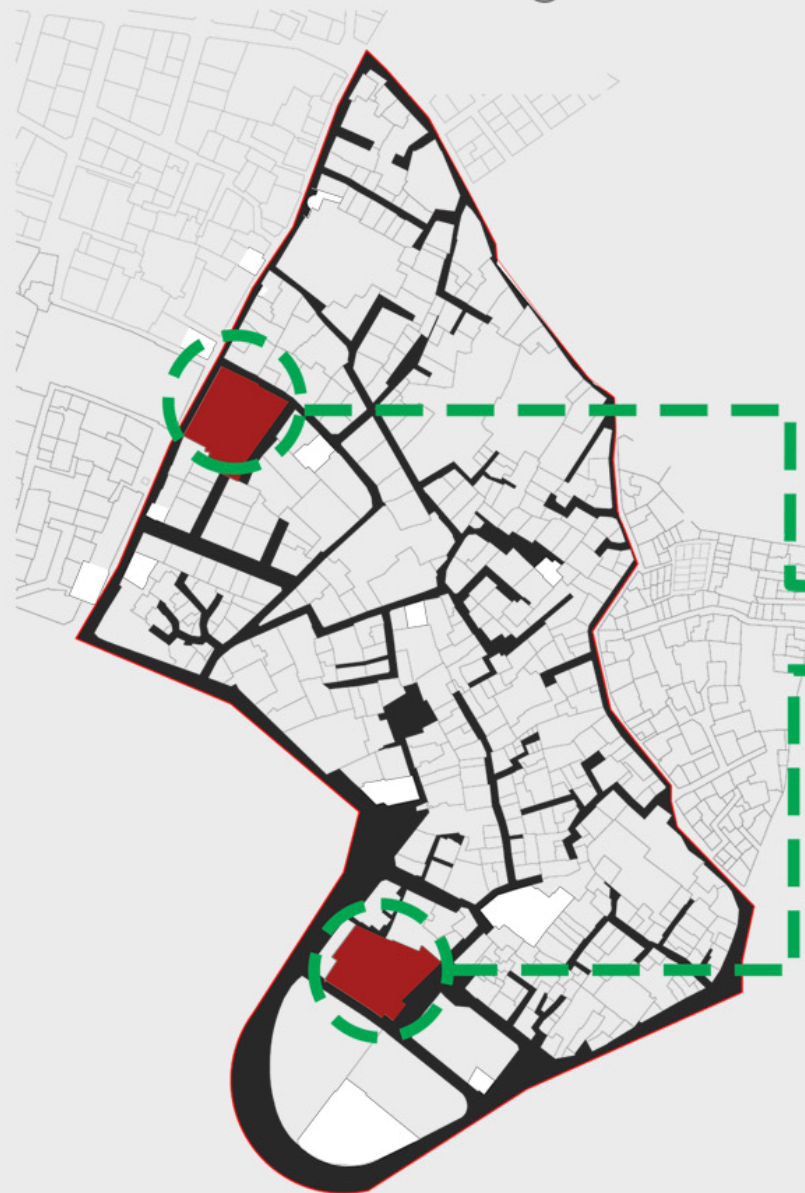

MADRASA ILJAY AL-YUSUFI (MAMLUKI)
 - VERY BEAUTIFUL STALACTITES OVER THE ENTRANCE.
 - UNIQUE CURVED RIBS OF THE DOME.
 - MOSHAHAR FACADE

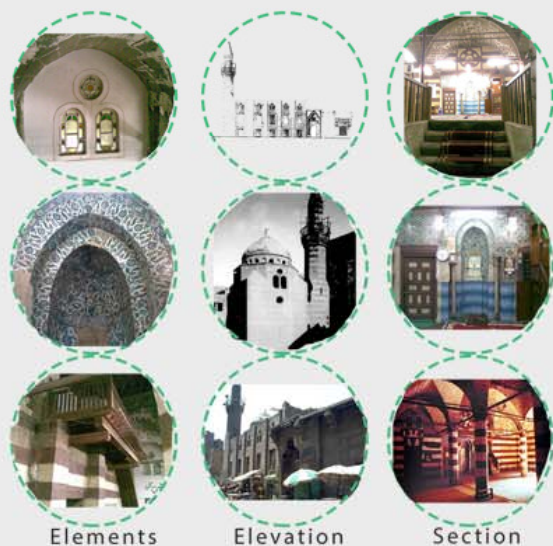
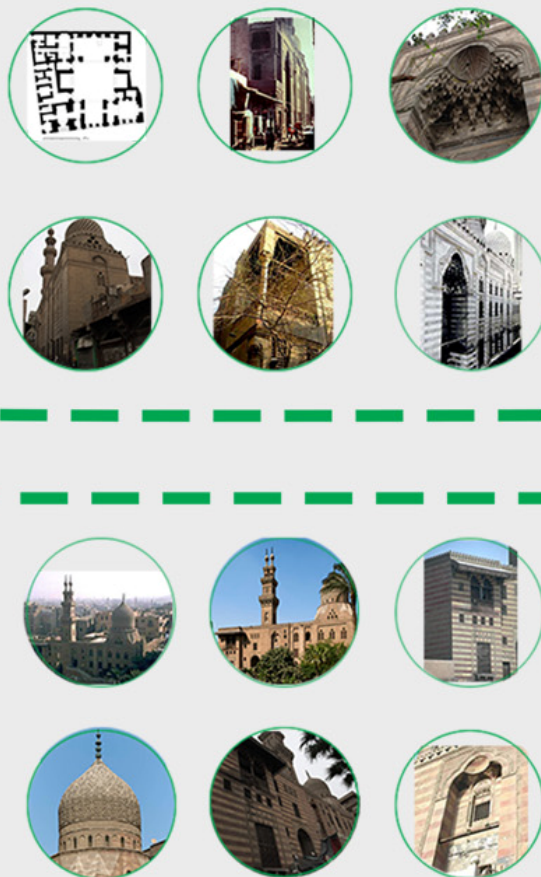

Elements

Elevation

Section

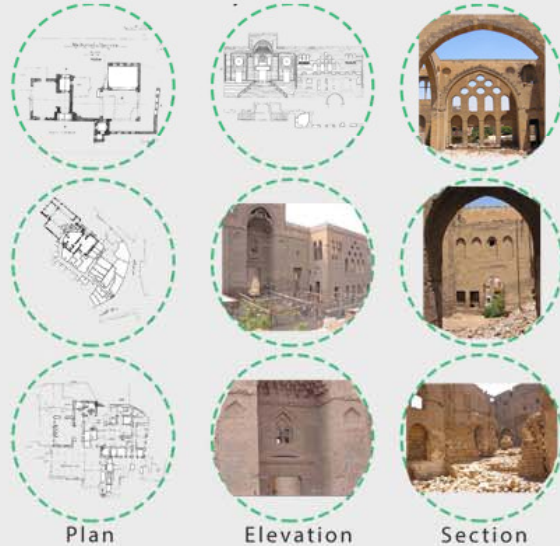

Plan

Elevation

Section

HERITAGE ELEMENTS

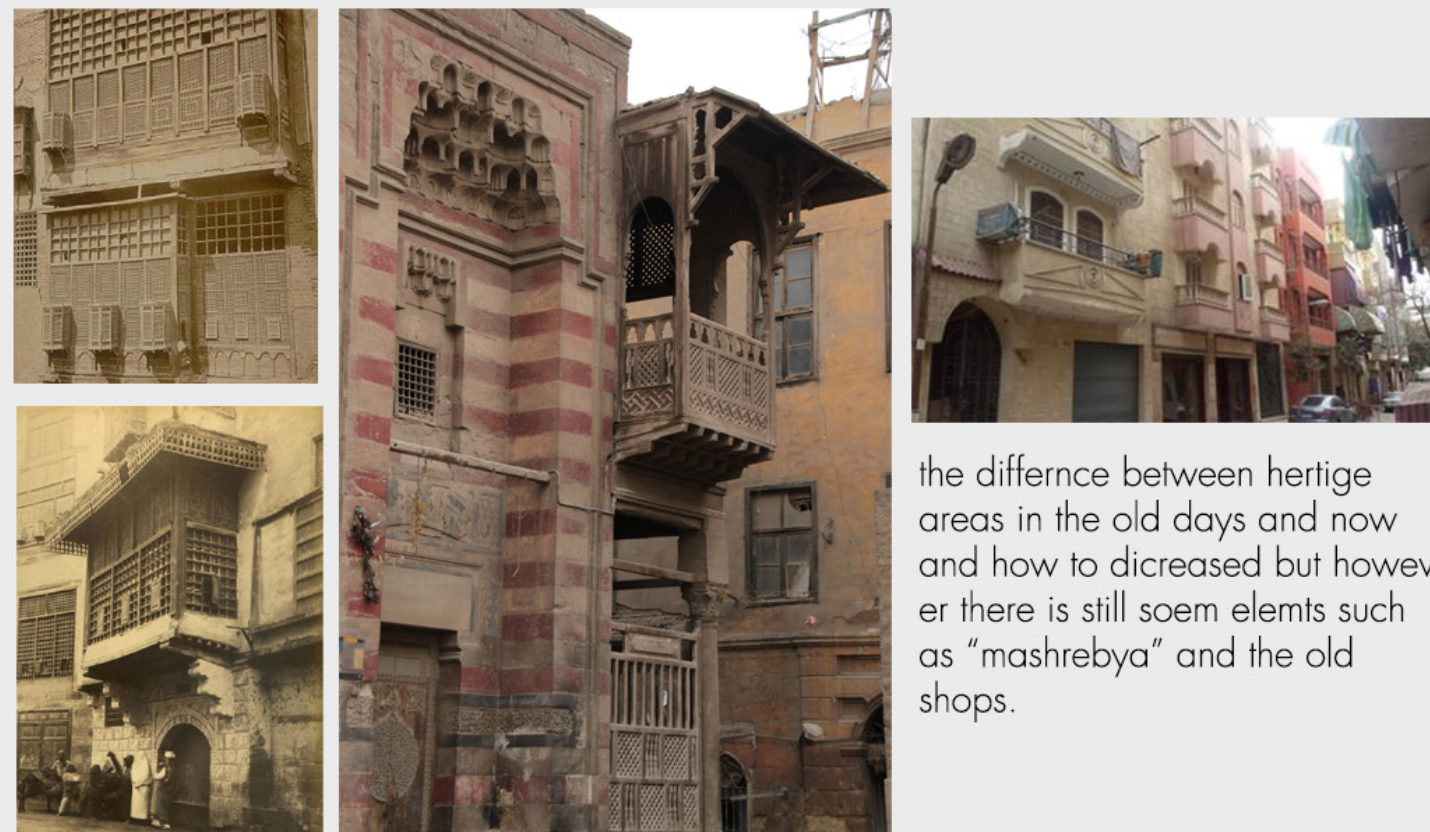

the difference between heritage areas in the old days and now and how it has decreased but however there are still some elements such as "mashrebya" and the old shops.

Old social habits:

- 1- old shops for selling pottery after making them.
- 2- people that used to be in certain places to clean shoes.
- 3- Shops for selling elements such as "shisha" and metal elements used for cooking.



بوابه قلب القاهرة بدرية احياء

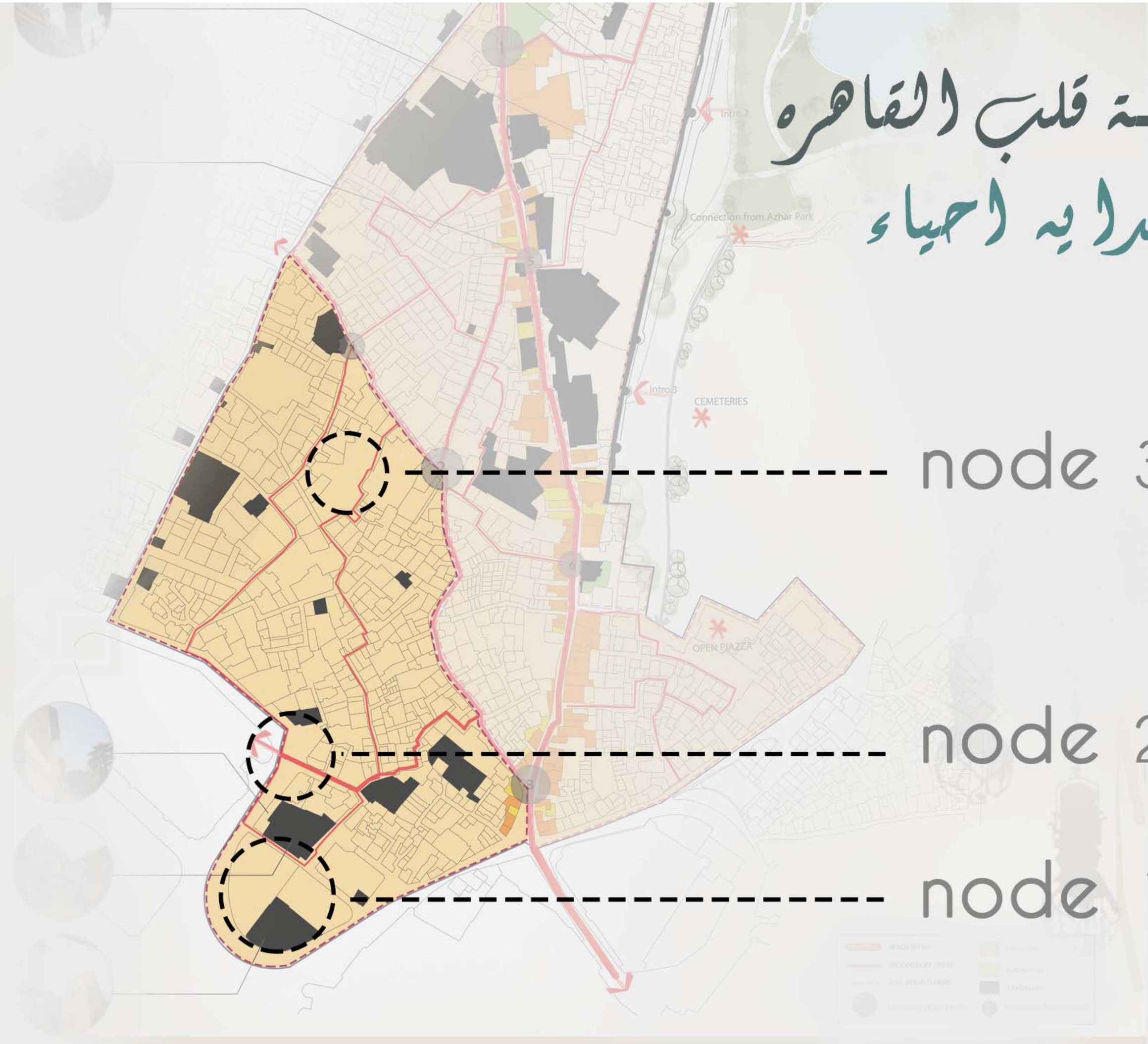

node 3

node 2

node 1

NODE 1

Utilising the contours of the land and build terraces to get the best view toward the historical mosques.

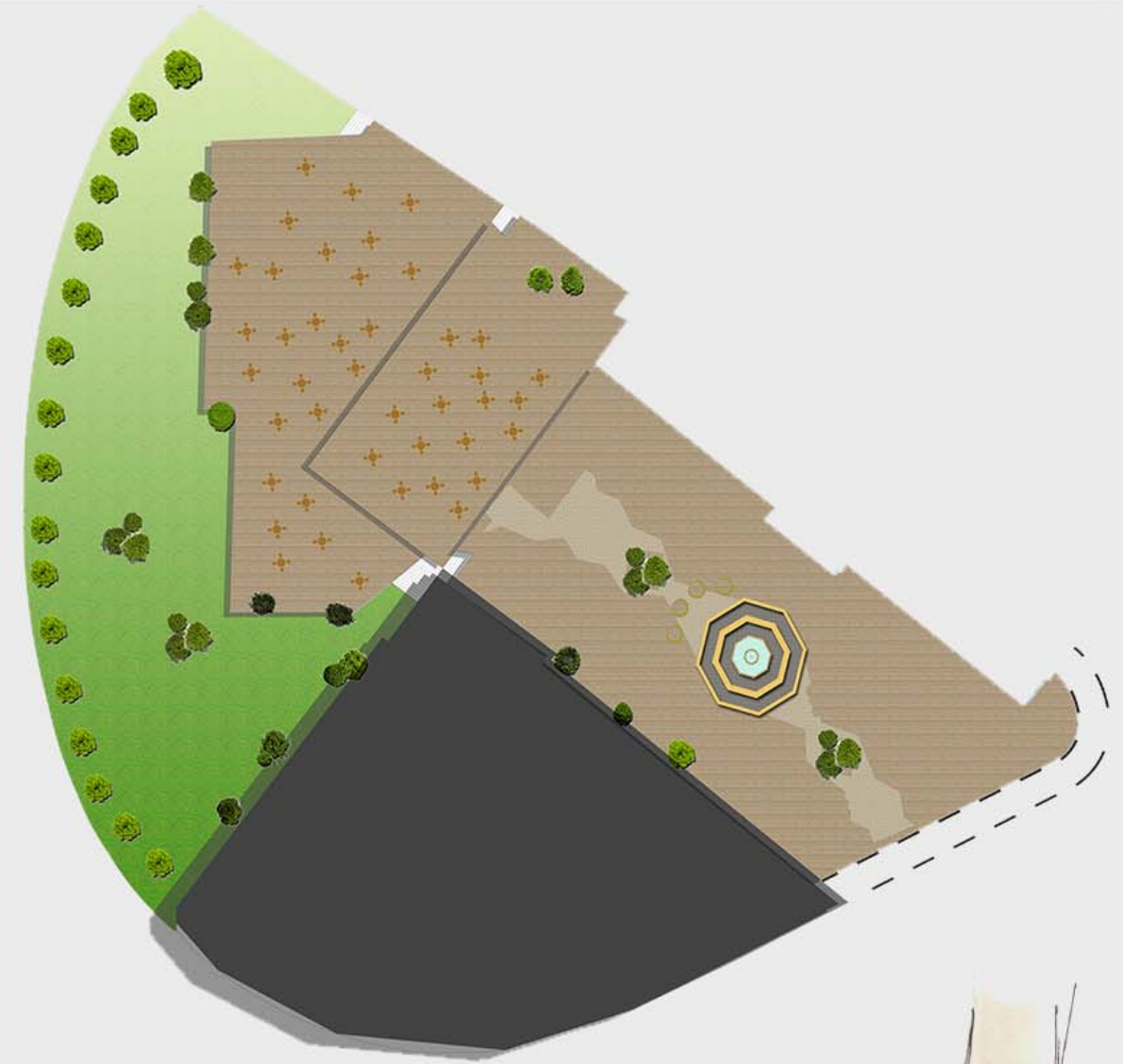



Time Line

Autumn

- Gathering point
- Events
-

Winter

- Field trips
- Christmas

Spring

- Eastern day
- Tourists Visits
- Labours day

Summer

- Tanuora festuval
- Art Galleries

Other

- Mawa'ed Al-Rahman in Ramadan
- Muslim Eids.

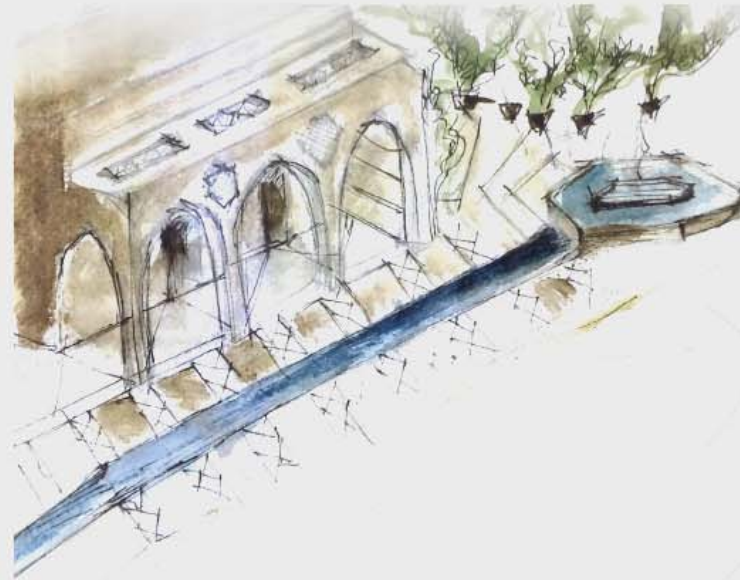
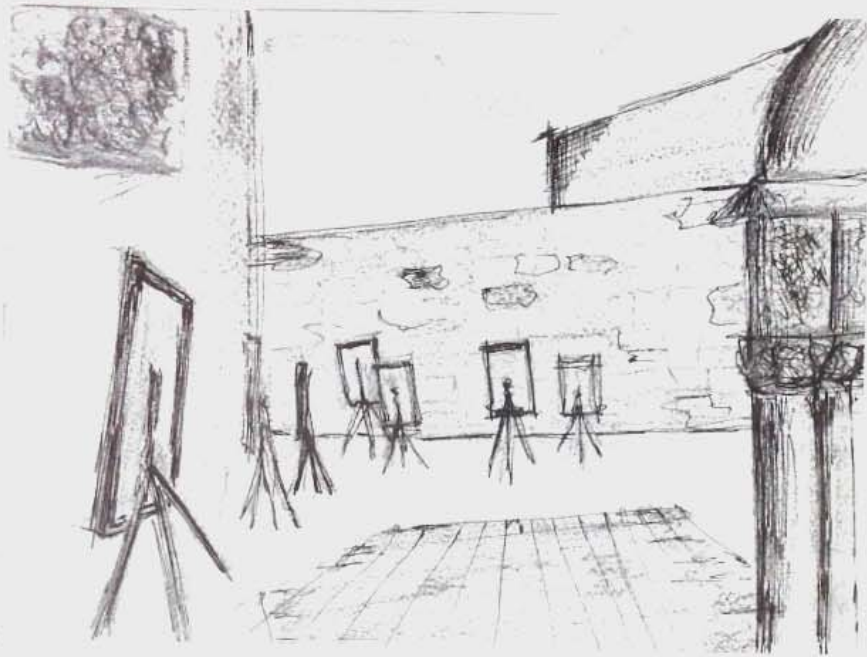

NODE 3

- Integration between the topography and monuments “mosque”
- Creating open space for people to have a drink in front of the magnificent view
- Activities such as reaching and souvenir shopping



3D Shot



Plan

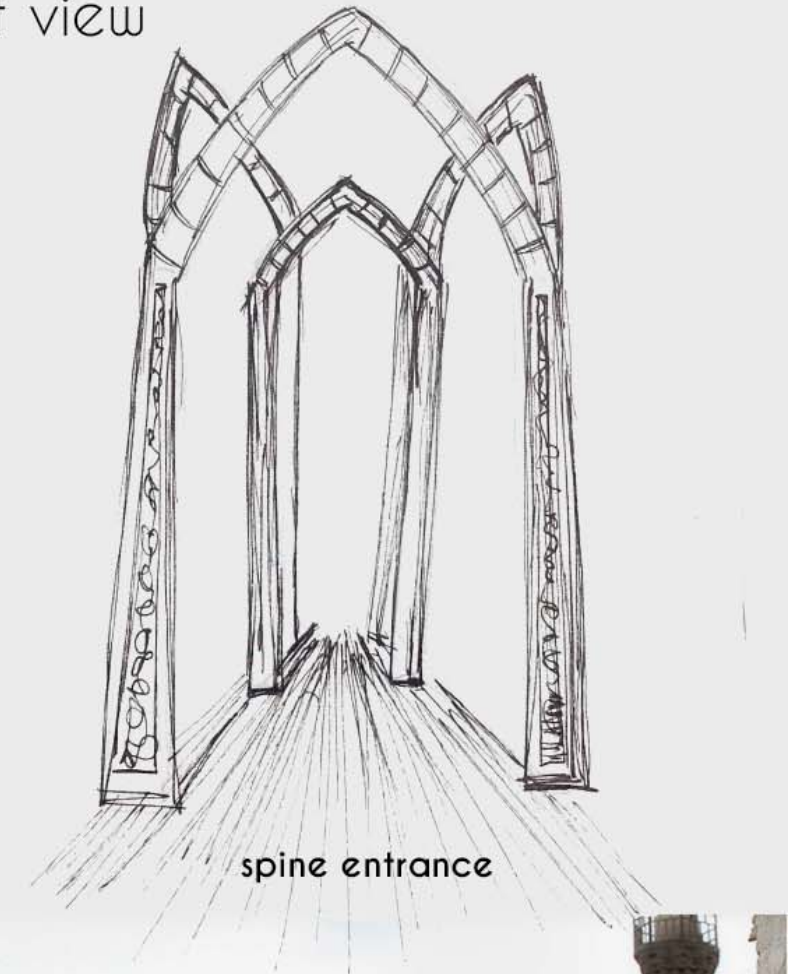

spine entrance



View from the Plaza